

Roofing Installation

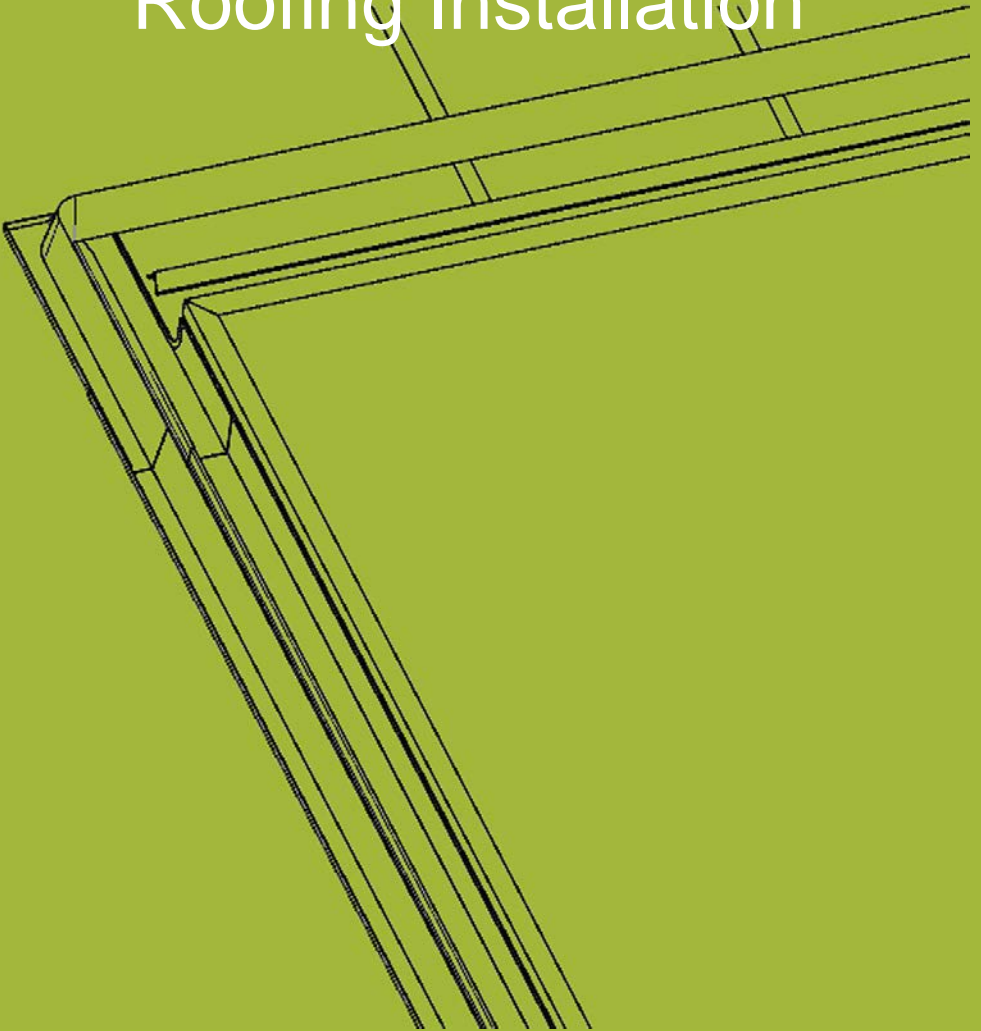

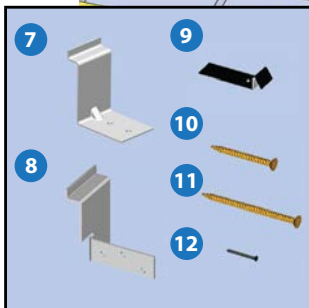

		VAT VCT	VAT16 VCT16
1	Solar Panel		
2	Sill Flashing	1	1
3	Lower Side Flashing	2	2
4	Upper Side Flashing (V20/PV20)	2	-
5	Upper Side Flashing (V30/PV30)	2	-
6	Top Flashing	1	1
7	Panel Rafter Bracket	4	4
8	Panel Side Bracket	6	4
9	Flashing Fixing Tab	18	12
10	4 x 25mm Screw	12	8
11	4 x 50mm Screw	8	8
12	25mm Nail	18	12

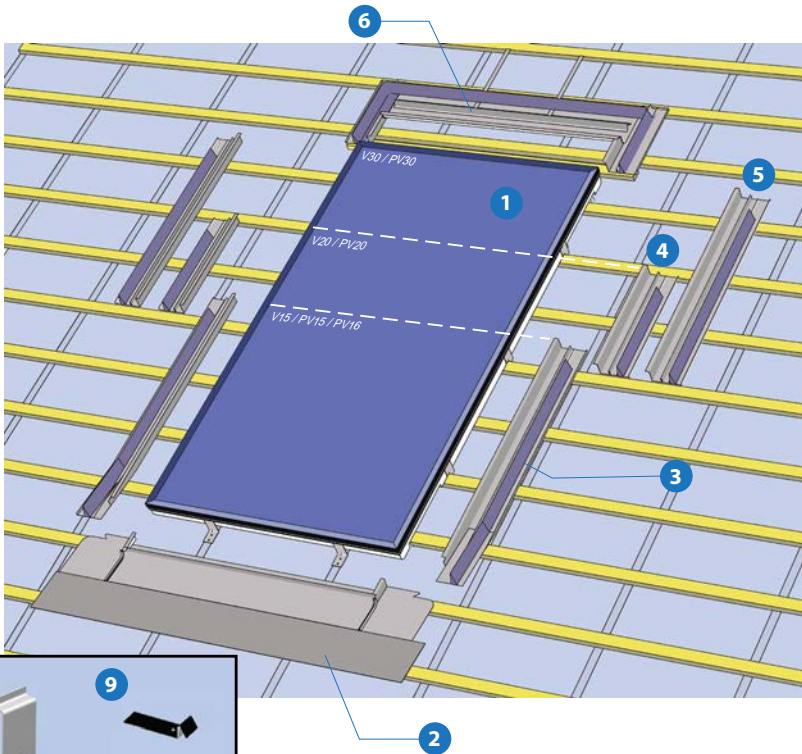
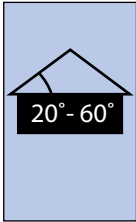
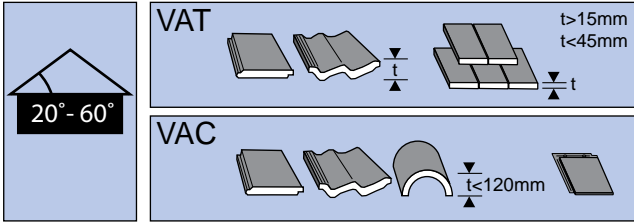

Viridian Solar recommends that the panel installation is carried out by an installer with roofing competence. The installation must comply with local regulations on lightning protection.

1

Setting out

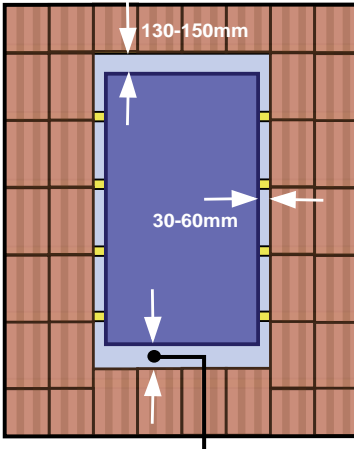

V15	31
V20	42
V30	62
PV15	29
PV16	21
PV20	40
PV30	56

Use mechanical lift to roof height where possible



Interlocking tiles set gap 130-150mm typical. Reduce for thinner tiles, if unsure - contact us

2

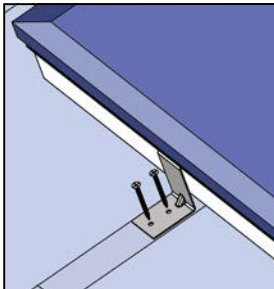
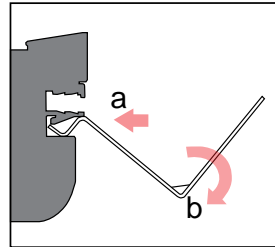
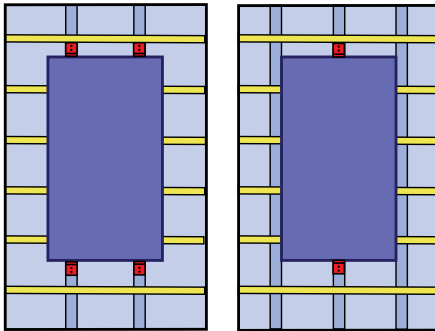

Fix panel with rafter brackets (7) at top and bottom with 2no. 50mm screws (11) per bracket. Depending on rafter location, use either 2 or 4 brackets.

3

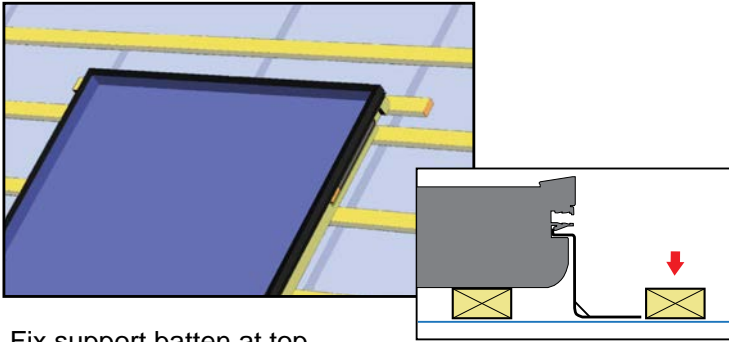

Fix support batten at top

4a

V15
V20
V30

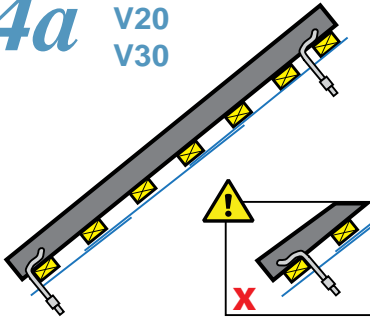

Position panel so hoses avoid rafters. Pass 2no. flexible hoses through membrane. Tape around hose to seal membrane. Always take hose downhill.

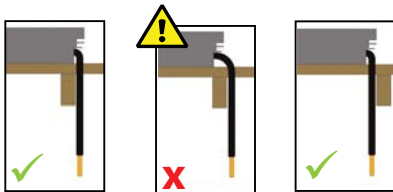

4b

PV15 PV16
PV20
PV30

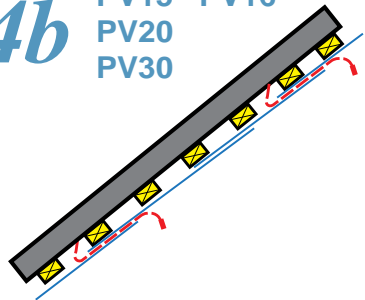

Feed 2 electrical connections up between membrane laps and into the roof space behind.

5

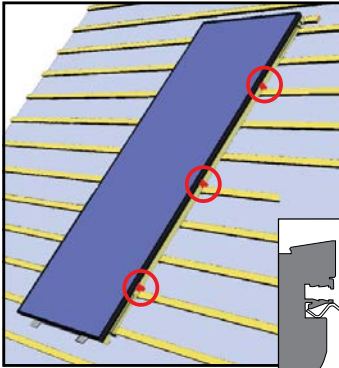

Attach panel side brackets (8) Use 3 each side for V30/PV30, 2 each side for other solar panels. Fix to battens using 2no. 25mm screws (10) per bracket.

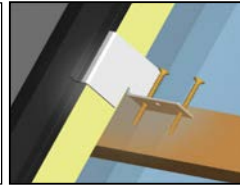
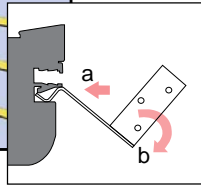

6

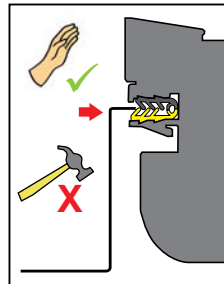
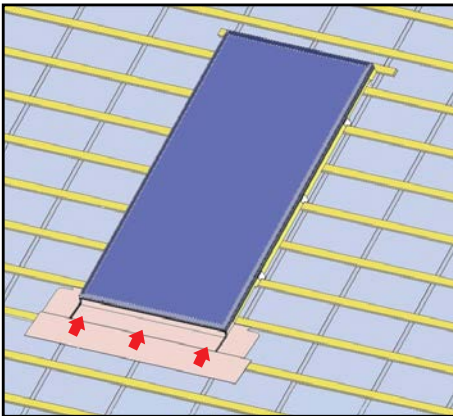

Carefully push sill flashing (2) into rubber seal at bottom of panel. If lubrication is required, use soapy water.

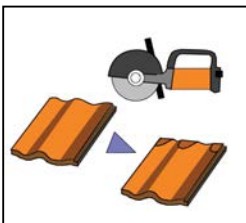

For some tile types it may necessary to chamfer the high points under the sill flashing.

7

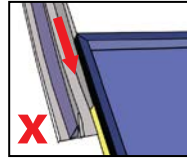
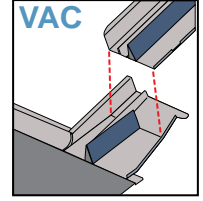
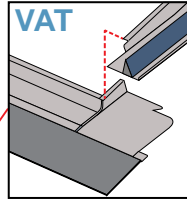
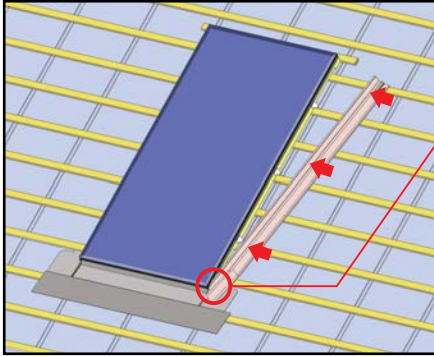

Join side flashings if in two pieces (V20, V30, PV20, PV30) using tabs provided. Push side flashings into side seal. Do not attempt to slide from top.

8

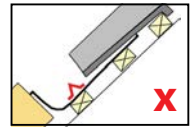
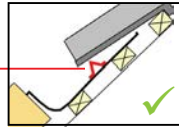
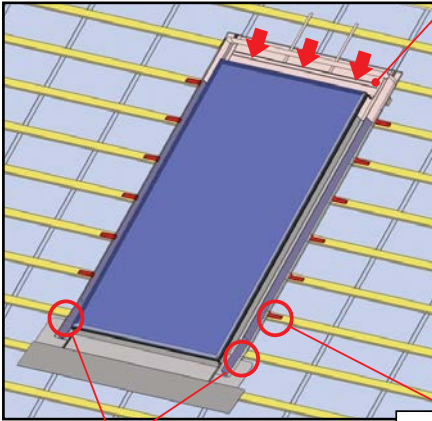

Push top flashing into seal. Secure side flashings to tile battens with flashing tabs. Tile around. Dress lead into tiles using lead mallet.

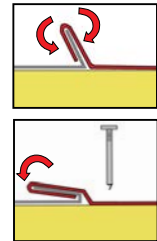
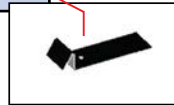
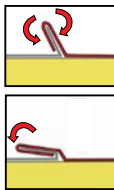
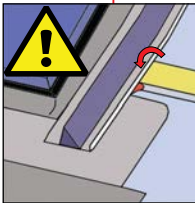

Clearline[®]

Viridian Solar
Atlas Building, Stirling Way
Papworth, Cambridge.
CB23 3GY
T 01480 831 501
F 01480 831 831
www.viridiansolar.co.uk

