

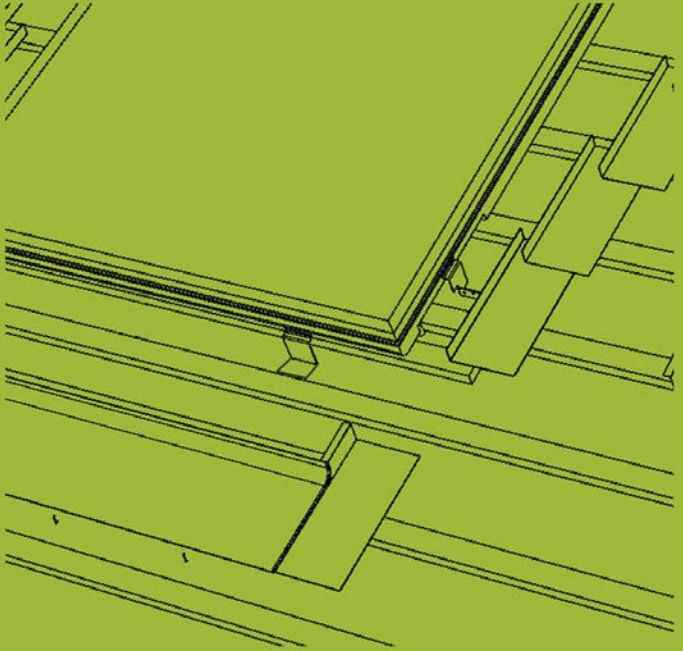

Roofing Installation

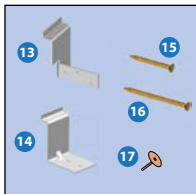

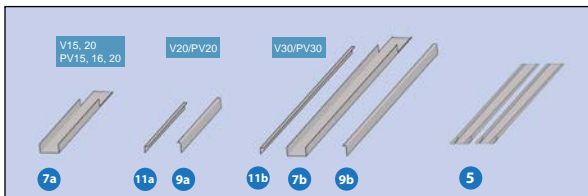
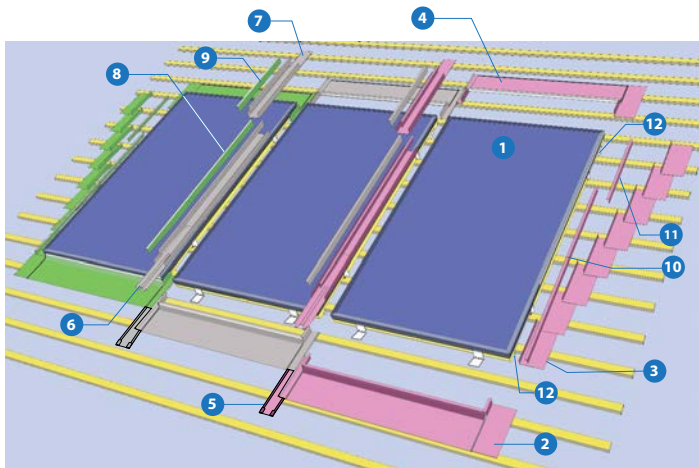

		VSL	VSC	VSR	VSL16	VSC16	VSR16
1	Solar Panel						
2	Sill Flashing	1	1	1	1	1	1
3	Soaker	14	0	14	8	0	8
4	Top Flashing	1	1	1	1	1	1
5	Joining Strip	0	2	2	0	2	2
6	Lower Gutter	0	1	1	0	1	1
7a	Upper Gutter (V15, 20 PV15, 20, 16)	0	1	1	0	1	1
7b	Upper Gutter (V30/PV30)	0	1	1	0	0	0
8	Lower Gutter Cover	1	2	1	1	2	1
9a	Upper Gutter Cover (V20/PV20)	1	2	1	0	0	0
9b	Upper Gutter Cover (V30/PV30)	1	2	1	0	0	0
10	Lower Side Cover	1	0	1	1	0	1
11a	Upper Side Cover (V20/PV20)	1	0	1	0	0	0
11b	Upper Side Cover (V30/PV30)	1	0	1	0	0	0
12	Flexi Hose						
13	Panel Fixing Bracket	6	6	6	4	4	4
14	Panel Rafter Bracket	4	4	4	4	4	4
15	4 x 25mm Screw	12	12	12	8	8	8
16	4 x 50mm Screw	8	8	8	8	8	8
17	Slate Rivet	6	6	6	6	6	6



V15	31kg	PV15	29kg
V20	42kg	PV16	21kg
V30	62kg	PV20	40kg
		PV30	56kg

Use mechanical lift to roof height where possible



Viridian Solar recommends that the panel installation is carried out by an installer with roofing competence.

The installation must comply with local regulations on lightning protection.

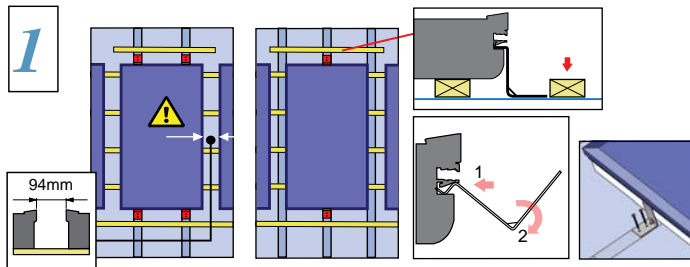

Fix panel with rafter brackets (14) at top and bottom with 2no. 50mm screws (16) per bracket. Depending on rafter location, use either 2 or 4 brackets. Ensure gap between panels is 94mm. Fit support batten above panel.

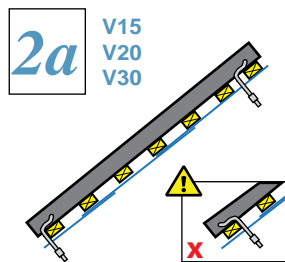

Position panel so hoses avoid rafters. Pass 2no. flexible hoses per panel through membrane. Tape around hose to seal membrane. Always take hose downhill.

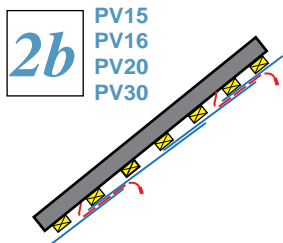
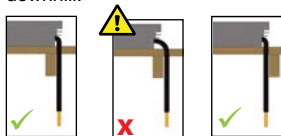

Feed 2 electrical connections per panel up between membrane laps and into the roof space behind.

3

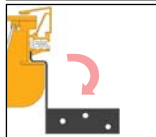
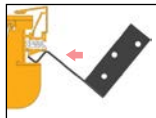
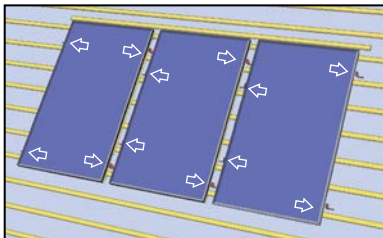

Attach panel side brackets (13) Use 3 each side for V30/PV30, 2 each side for other solar panels. Fix to battens using 2no. 25mm screws (15) per bracket.

4

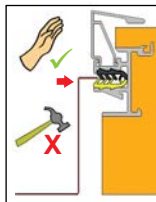
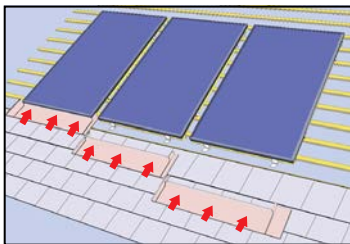

Carefully push sill flashing (2) into rubber seal at bottom of panel. If lubrication is required, use soapy water.

Slide joining strip (5) up behind the adjacent sill flashings and between the panels. Secure to a batten with a nail.

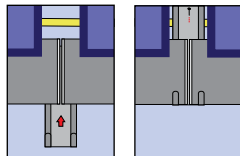

Retain sill flashing lower edge with slate rivets (17).

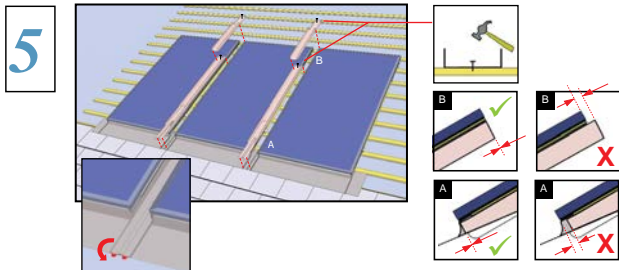

Fit gutters (6 then 7a or 7b) between panels, align carefully top and bottom. Fix with nails at top of each. Fold tabs under sill flashing (2)

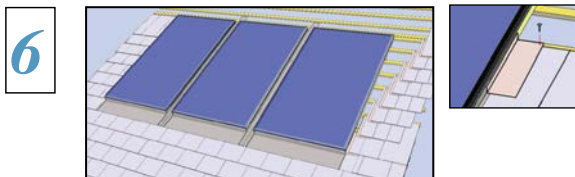

Fit soakers (3) against outside sides of panel. Interleave with slates and fix using a nail.

7

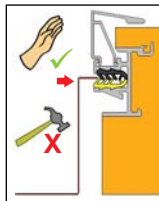
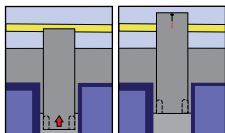
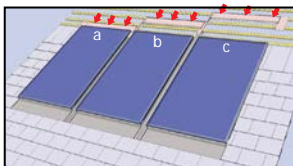

Push top flashings (4) into rubber seal at top of panels. Fix joining strip (5) over join with tabs behind top flashings. Secure joining strip with nail.

8

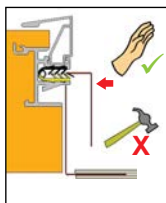
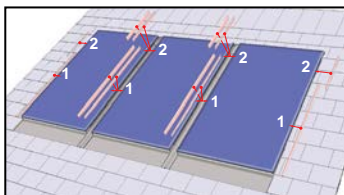

Push lower side cover (10) into side seal, push upper side cover (11a or 11b) - into side seal. Repeat for gutter covers (8), (9a, 9b). Upper covers not required for V15 / PV15,16. Fold down tabs at top corners of panel.

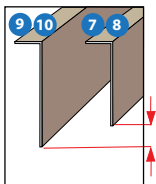

Clearline[®]

Viridian Solar
Atlas Building, Stirling Way
Papworth, Cambridge.
CB23 3GY
T 01480 831 501
F 01480 831 831
www.viridiansolar.co.uk

